



Work Sector
Client
Location
Cost
Date completed

Invite only competition - Masterplanning/Mixed Use/Office/Residential/Retail
CR City
Prague, Czech Republic
3.1 million Kc
2003

An invitation only competition design submission for a challenging site close to the main railway station in Prague and visible from the historic centre. The design entailed a mixed-use development containing offices, retail, penthouse flats and residential accommodation was carefully placed on existing contours. Hotel accommodation was designed as an option in place of residential space and a roof garden and landscape have been carefully integrated into the design.

Total floor area of development was 65 000sq.m with additional open and landscape spaces.

Churchill Square, Prague

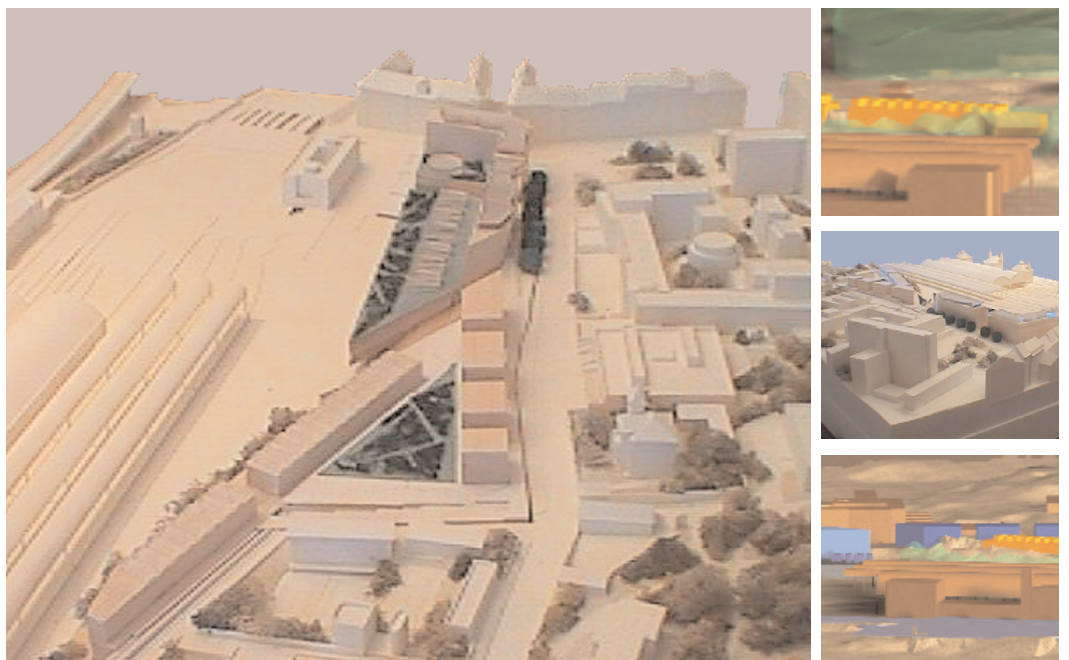

LEWIS AND
HICKEY