



Work Sector

Client

Location

Cost

Date completed

Education/Mixed Use/Masterplanning

St Modwen Properties Plc

Bedfordshire

Undisclosed

On-going

Lewis & Hickey London has put forward proposals for the ongoing development of the Cranfield University Technology Park, located between Milton Keynes and Bedford. A masterplan to create over 450,000 sq ft of commercial expansion to the existing facilities has been designed as part of an on-going collaboration between St Modwen Properties Plc and Cranfield University.

Our masterplan proposal establishes strong links, creates quality public spaces and landmark buildings that reinforce the tie between the Technology Park, the airport and the wider campus. It is the intention to develop the masterplan with sustainability at the forefront of the design process.

Lewis & Hickey have also put forward proposals for a 30,000sqft 3 storey office building, which would kick-starts the new phases of development.

# Cranfield University Technology Park

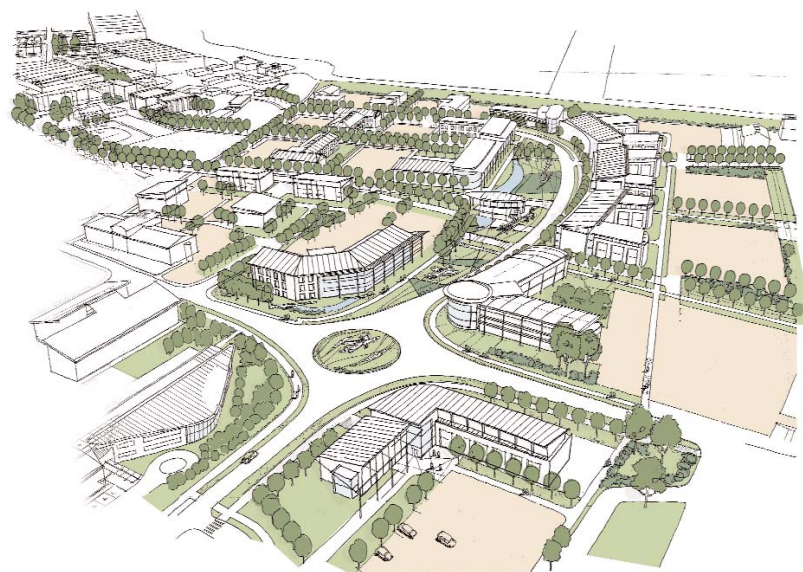

LEWIS AND  
HICKEY